

## Magnetic drive pumps

# MD series

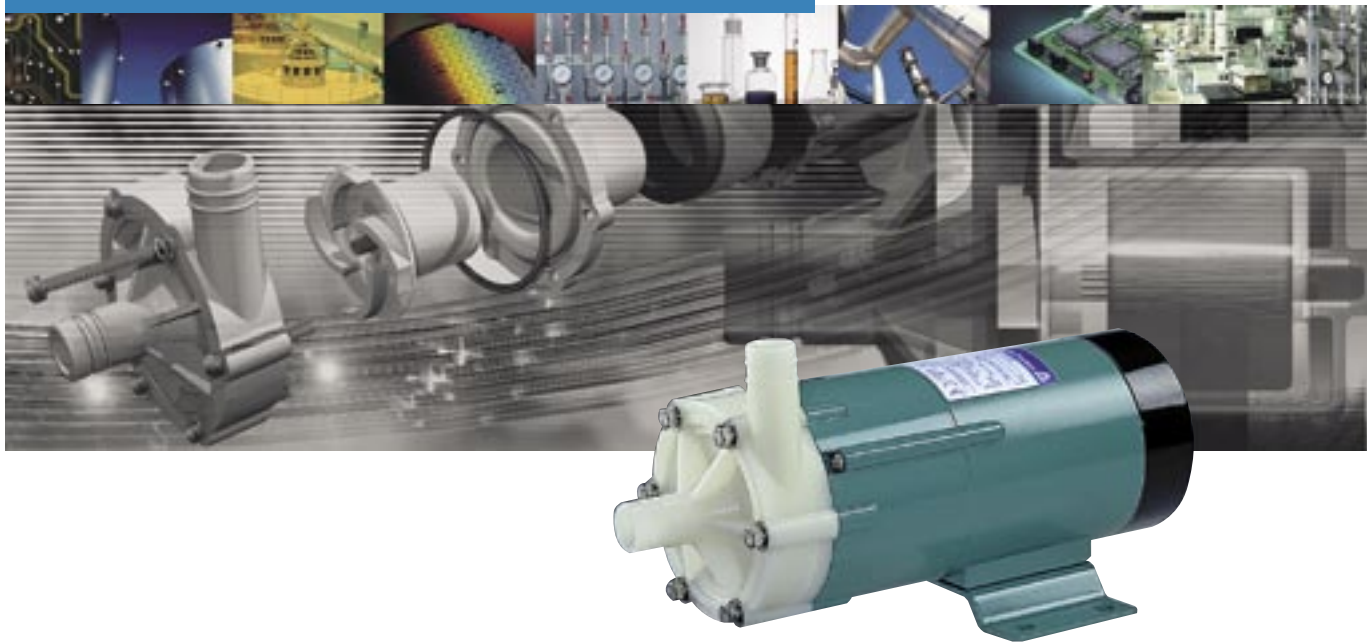

# MD series, one of the world's best-selling pumps

The MD/MD-F series are leak-proof, small-sized magnetic pumps, which are our best-selling product line and widely used in over 30 countries. The line's most attractive characteristic is its numerous model configurations. Models made from GFRPP and now CFRPVDF have been introduced for the MD series and their variants have been further improved. From inclusion into machines such as automatic photo processors and various analytical devices, these pumps can transfer all kinds of chemical liquids. The MD-F series is designed specially for highly corrosive chemicals and employs CFRETFE as its main material. It is widely used for surface treatment and transfer of fluids containing strong acids/strong alkalies in liquid crystal manufacture.

## No leakage

These are seal-less pumps using a magnetic drive system. Since there is no possibility of seal leakage, all problems relating to seal wear & replacement have been eliminated. The pumps are ideally suited to original equipment inclusion due to their compact design.

## High durability

A CFRPVDF type (MD-V model) now supplements the GFRPP type on 6 models. Application on electrolyzed water and alkaline baths for enhanced surface treatment are now possible. The MD-F series using CFRETFE as its main material can handle nearly all types of chemical liquids including strong acids/ alkalies and organic solvents.

## Applicable on high specific gravity fluids

The MD-F series is designed and intended for use with heavier liquid fluids such as strong acids. To handle high specific gravity requirements, 3 types of impeller are available depending on the intended liquid.

## Various models

There are a total of 50 models in the MD series. In addition to the standard versions, there are special models for high-head (MD-Z), high flow rate (MD-X) and with screwed connections (MD-M). The product line now contains more variants than ever before, for maximum application flexibility.

## Easy maintenance

Since the pump's structure consists of only a few integrated parts, disassembly and inspection are very easy.

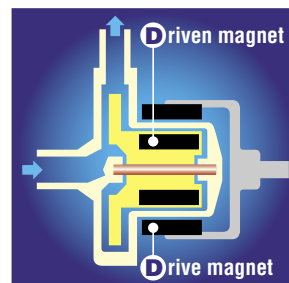

## Operating Principle

The centrifugal pump is driven by a pair of magnets which are incorporated in the impeller and motor shaft. The sealless pump structure eliminates shaft seals such as conventional mechanical seals because the pump chamber is shielded by the casings and the impeller is operated by the magnets. The combined coupling torque of the drive magnet and impeller magnet gives sufficient driving power against the motor torque.



MD-6



MD-10



MD-15R-N



MD-20R-N



MD-30R-N

A variety of models from 5.5 l/min to 135 l/min is available.

## MD series

### Thread type

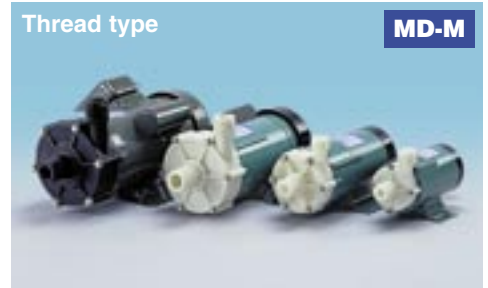
**MD-M**

MD-100RM, 55RM-N, 30RM-N, 15RM-N

### High head type

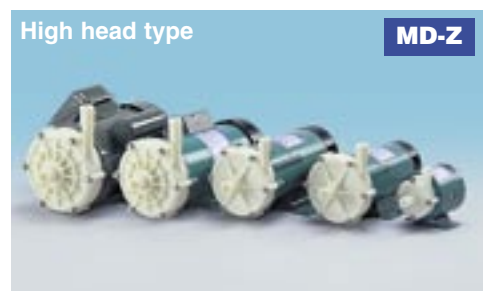
**MD-Z**

MD-70RZ, 40RZ-N, 30RZ-N, 20RZ-N, 6Z

### High capacity type

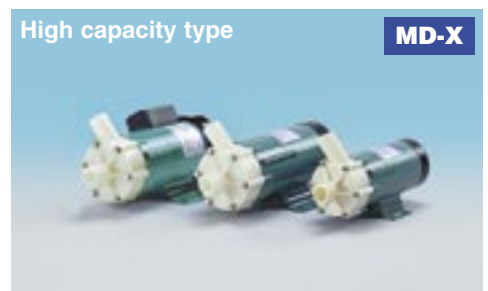
**MD-X**

MD-40RX-N, 30RX-N, 20RX-N

## MD-V series

### CFRPVDF type

**MD-V**

MD-70RVM, 30RV-N, 15RV-N

## MD-F series

### CFRETFE type

**MD-F**

MD-100F, 55F, 30F-N, 15F-N





## Extremely simple structure eliminates corrosion and leakage

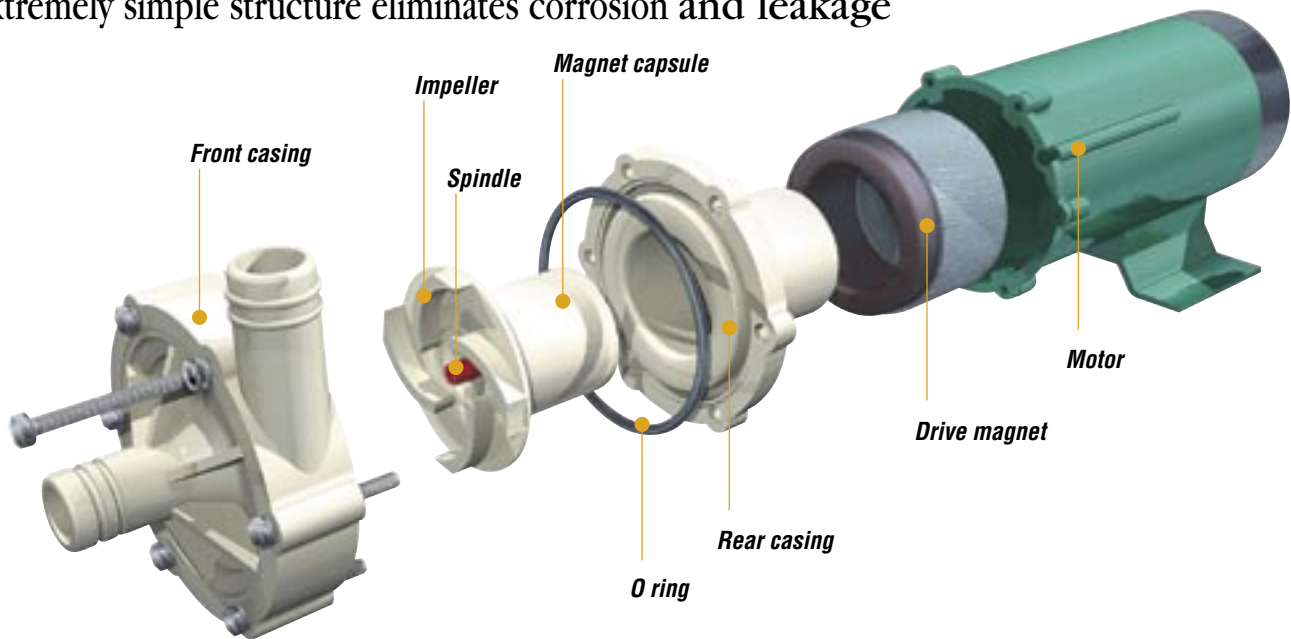

### Front casing

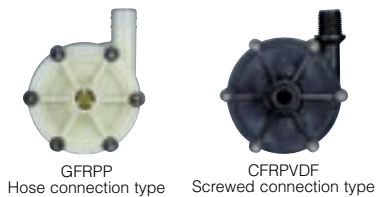

**MD MD-V**

Casings are made from either GFRPP or CFRPVDF (MD-V). Both materials are available with either hose connections or screwed connections (MD-M) depending on application. Screwed connection versions can additionally be fitted with either flanges or union joints types for further flexibility.

Note: Screwed Connection is not available for MD-6, 6Z, 10 and 15RV-N types due to their small sizes. Hose connection is option for MD-V.

**MD-F** The pumps are made from injection molded carbon-fiber-filled ETFE. As a matter of course, screwed pipe connections are standard with safety as the primary consideration.

### Rear casing

**MD MD-V** The MD model uses GFRPP and the MD-V model uses CFRPVDF materials. Both types are an integrated design with bearings mounted in the ends to support the spindle.

Note: Bearings are not used on MD-6K-N/6ZK-N/10K-N models due to their small size.

**MD-F** CFRETFE models also use integrated bearings mounted in the rear casings similar to other MD models.

### Impeller

**MD MD-V** The MD model is made from GFRPP and the MD-V model is made from CFRPVDF, with both types incorporating moulded-in ferrite magnets.

The hollow, rotating Alumina ceramic spindle is integrated into this magnet. Open/closed/semi-open impeller configurations can be selected depending on liquid characteristics.

Note: MD-6, 6Z and 10 models use a fixed-

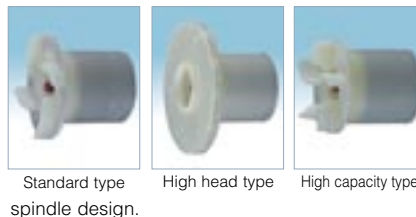

**MD-F** The integrated closed impeller is made from CFRETFE. 3 types (X/Y/Z) of impeller diameters are standardized to cover all specific gravity requirements.



### Drive magnet

The drive magnet is magnetized barium ferrite for 4-, 6-, or 8-poles. It rotates the impeller by using the magnetic field from the outside of the rear casing.

### Special accessories

#### • Union joint

Special-purpose union joints are available to cope with three types (13mm, 16mm and 20mm dia.) of piping. Tight sealing O-rings are used to prevent thread damage caused by over tightening.



MD-30RM-N

#### • Self-priming chamber

Once fill up liquid, repriming is not required. It is very easy to use MD pump with self-priming chamber.



Attached to: SC-4 for 30RM-N and 40RM-N, SC-7 for 70RM

Connections(Inlet X Outlet): G3/4(SC-4)/G1(SC-7)  
Suction limit: 0.8m(SC-4)/1.2m(SC-7)

Note: Self-priming height depends on liquid temperature and characteristics.

## Construction and materials

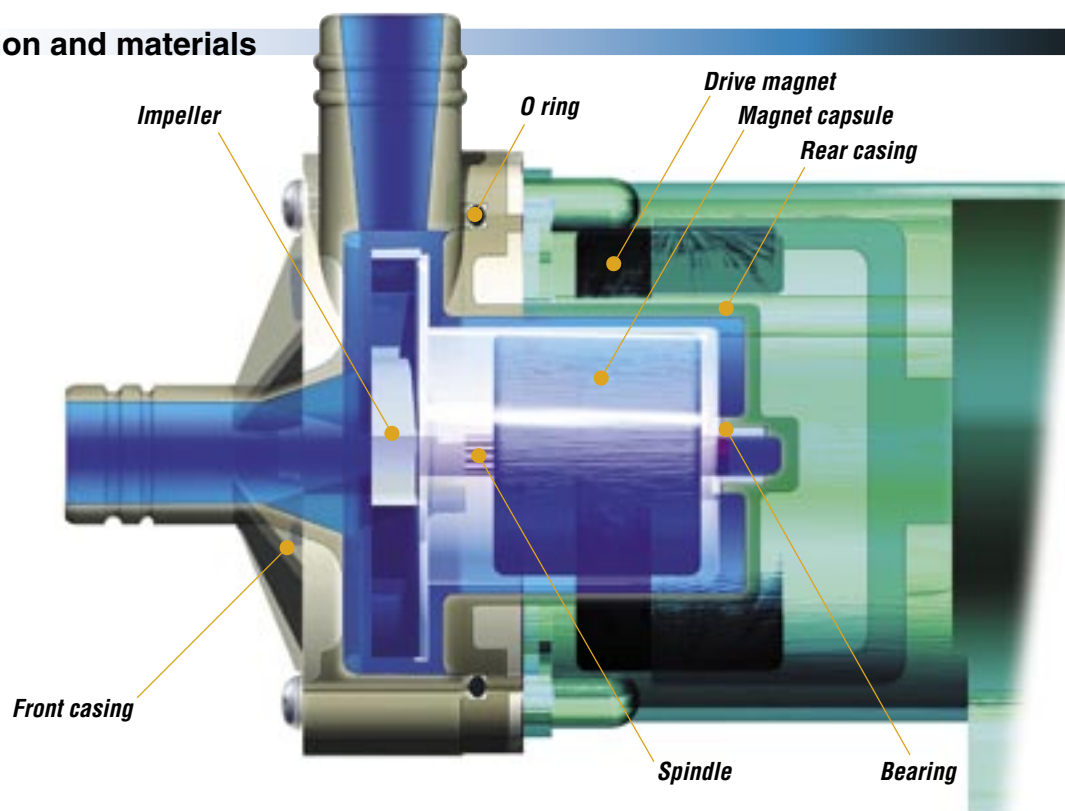

### Wet-end materials

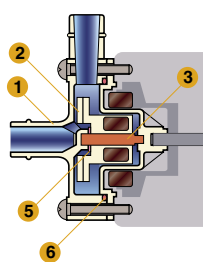

MD-6

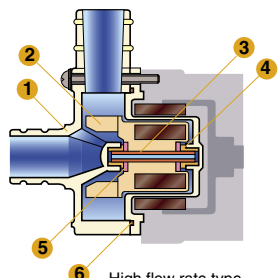
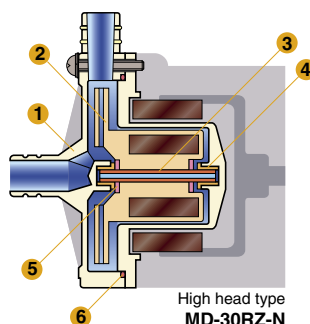
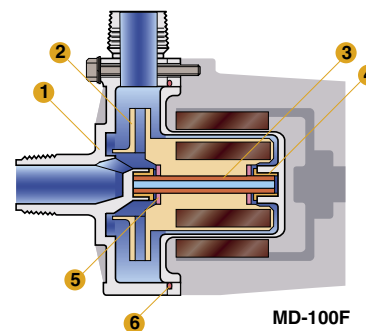
High flow rate type  
MD-20RX-N

High head type  
MD-30RZ-N

MD-100F

#### MD

Part	Material
1 Casing	GFRPP
2 Impeller	GFRPP or CFRPP
3 Spindle	Alumina ceramic
4 Bearing	PTFE
5 Thrust ring	Alumina ceramic or PE
6 O-ring	FKM or EPDM

Note1: Bearing material of MD-40RZ-N and 70RZ is PPS.

#### MD-V

Part	Material
1 Casing	CFRPVDF
2 Impeller	CFRPVDF
3 Spindle	Alumina ceramic
4 Bearing	PTFE
5 Thrust ring	Alumina ceramic or PE
6 O-ring	FKM or EPDM

Note2: Bearing material of 70RZV is PPS.

#### MD-F

Part	Material
1 Casing	CFRETFE
2 Impeller	CFRETFE
3 Spindle	Silicon carbide
4 Bearing	Silicon carbide
5 Thrust ring	Silicon carbide
6 O-ring	FKM (fluoroelastomer)

Note3: EPDM or Atlas® are also available on special request.

## Pump identification

### MD-6 to 10

**MD-6 Z V - N**  
1 2 3 4

1	Pump size	6 to 10
2	Type	No mark: Standard type Z: High head type
3	Material of casing	No mark: GFRPP V: CFRPVDF
4	Motor	N: 100V, 220N: AC220/240V(or 230V), single phase

### MD-15 to 100

**MD-30 RZ V M - 220N**  
1 2 3 4 5

1	Pump size	15 to 100
2	Type	R: Standard type RZ: High head type RX: High capacity type
3	Material of casing	No mark: GFRPP V: CFRPVDF
4	Connection	No mark: Hose type M: Screwed type
5	Motor	N: AC100V, 200N: AC200, 220N: AC220/240V(or 230V), single phase No code of voltage for MD55R to MD100R.

Note4: Please ask us for model code of MD-F Series.

## Performance curves

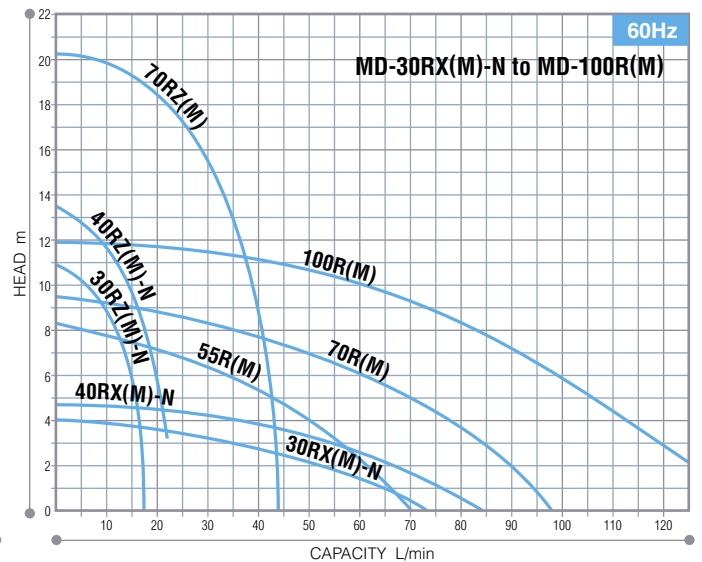
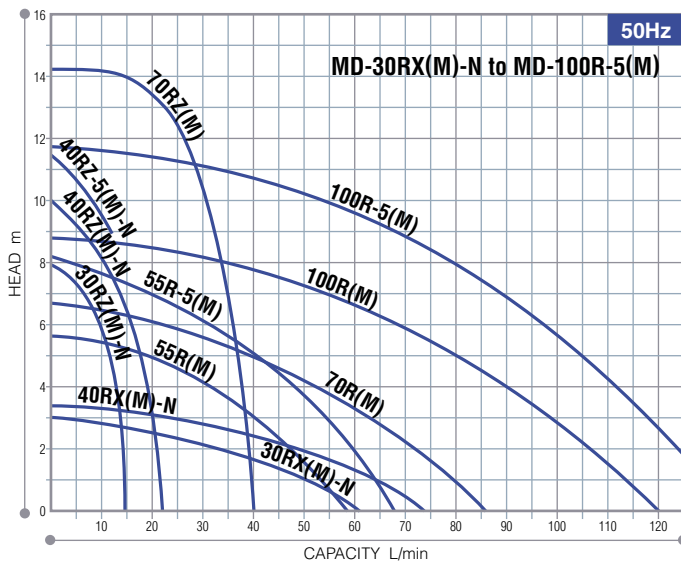
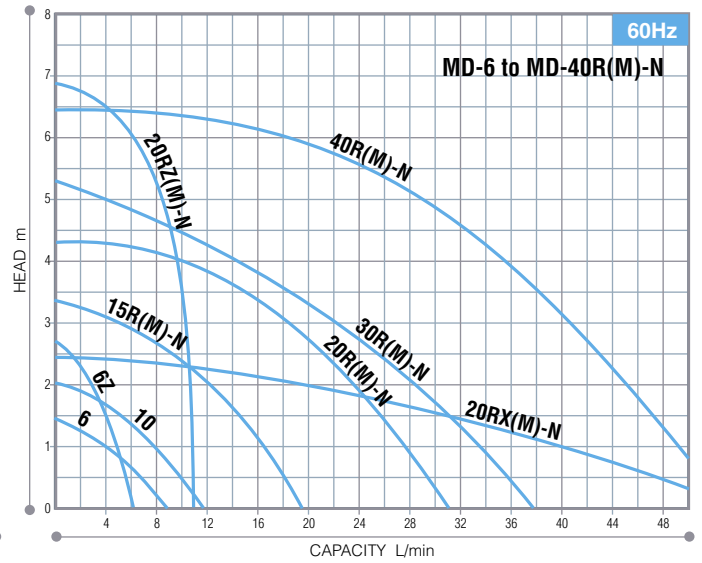
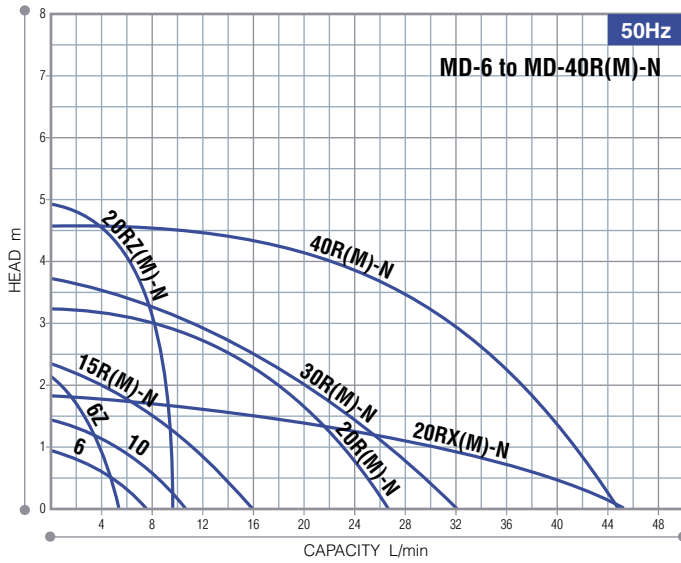

Note: Performance is based on pumping clear water at ambient temperature. Do not run pump with discharge valve closed because pump life may be shortened.  
MD-40RZ-N model makes water noise when used at head of 6 meters (50 Hz)/7 meters (60Hz) or below.

## Specifications

50Hz/60Hz

Model	Hose connection		Screw connection		Note	Max. Capacity L/min	Max. Head m	S.G.	Motor			Mass kg
	Inlet	Outlet	Inlet/Outlet	Union					Output W	Input W	Phase	
MD-6	14mm	14mm	-	-		8.0/9.0	1.0/1.4	1.2	3/3	22/22	1	0.9
MD-6Z	14mm	14mm	-	-		5.5/6.0	2.1/2.7	1.1	3/3	24/23	1	0.9
MD-10	14mm	14mm	-	-		11/12	1.5/2.1	1.1	6/6	35/35	1	0.9
MD-15R(M)-N, 15RV-N	14mm	14mm	G 3/4	13mm		16/19	2.4/3.4	1.3	10/10	26/31	1	1.6
MD-20R(M)-N	18mm	17mm	G 3/4	16mm		27/31	3.1/4.3	1.1	20/20	40/50	1	2.0
MD-20RZ(M)-N, 20RZV(M)-N	17.5mm	17mm	G 3/4	13mm		10/11	4.9/6.9	1.1	20/20	40/50	1	2.0
MD-20RX(M)-N	26mm	26mm	G 1	20mm		46/52	1.8/2.5	1.3	20/20	40/50	1	2.0
MD-30R(M)-N, 30RV(M)-N	20mm	20mm	G 3/4	16mm		32/38	3.8/5.4	1.3	45/45	60/80	1	3.5
MD-30RZ(M)-N, 30RZV(M)-N	17.5mm	17mm	G 3/4	13mm		15/17	8.0/11	1.0	45/45	70/90	1	3.5
MD-30RX(M)-N	26mm	26mm	G 1	20mm		62/72	2.9/4.1	1.1	45/45	70/90	1	3.5
MD-40R(M)-N	20mm	20mm	G 3/4	16mm		45/52	4.6/6.5	1.1	65/65	90/130	1	3.9
MD-40RZ(M)-N	20mm	20mm	G 3/4	16mm		22/22	10/13.5	1.0	65/65	140/200	1	3.9
MD-40RZ-5(M)-N	20mm	20mm	G 3/4	16mm		11/-	11.5/-	1.0	65/-	140/-	1	3.9
MD-40RX(M)-N	26mm	26mm	G 1	20mm		75/85	3.3/4.7	1.1	65/65	85/120	1	3.9
MD-55R(M)	26mm	26mm	G 1	20mm		60/70	5.6/8.2	1.2	90/90	130/170	1	5.4
MD-55R-5(M)	26mm	26mm	G 1	20mm		70/-	8.2/-	1.2	90/-	170/-	1	5.4
MD-70R(M), 70RV(M)	26mm	26mm	G 1	20mm		86/97	6.7/9.7	1.0	150/180	265/365	1 or 3	6.0
MD-70RZ(M), 70RZV(M)	20mm	20mm	G 3/4	16mm		40/43	14.3/20.3	1.0	180/216	275/395	1 or 3	6.0
MD-100R(M)	26mm	26mm	G 1	20mm		120/135	8.6/11.9	1.2	260/265	245/365	1 or 3	8.5
MD-100R-5(M)	26mm	26mm	G 1	20mm		135/-	11.7/-	1.1	260/-	365/-	1 or 3	8.5

• Temperature range: 0 - 80°C • Ambient temperature : 0 to 40°C • Limit of viscosity: 30mPa•s (at specific gravity 1) • Slurries shorten pump life.  
Note: Size of union is nominal dia. of mated PVC pipe. Allowable temperature range is 0 to 55°C.  
• Allowable liquid temperature may depend on pumped liquid and operating condition such as heat cycles or so. Please contact us for details.  
• MD-40RZ-5(M)-N, 55R-5(M) and 100R-5(M) models are exclusive use for 50 cycle frequency.

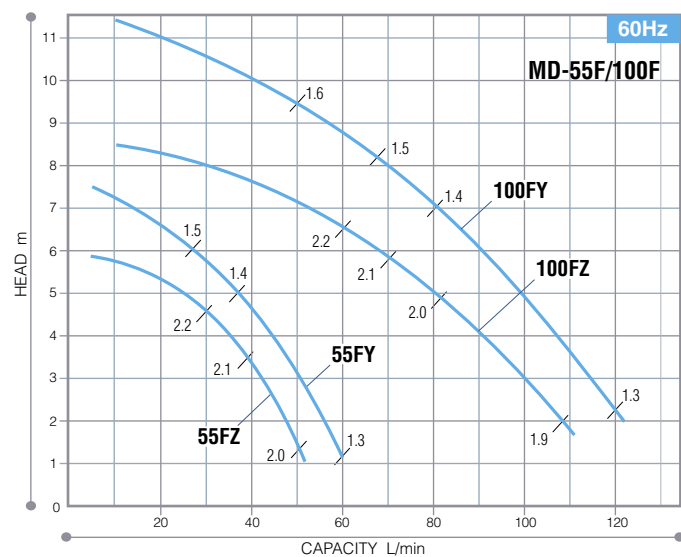
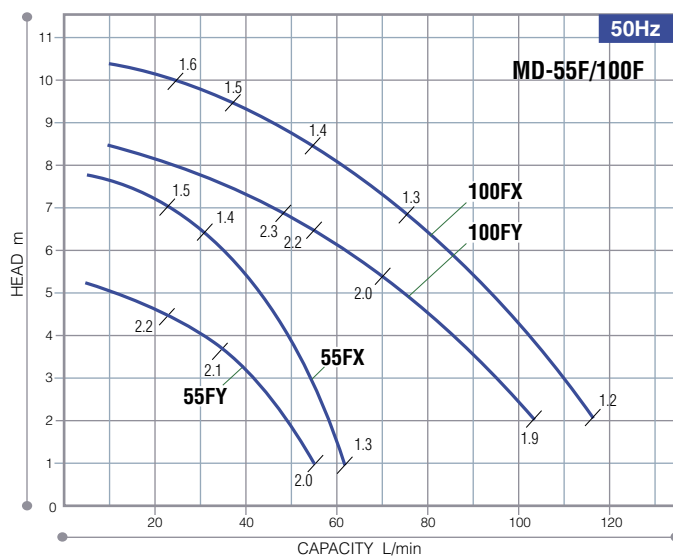
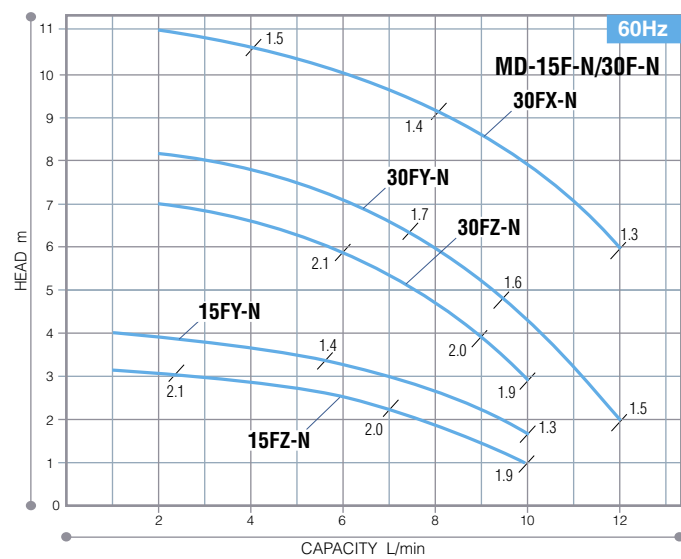
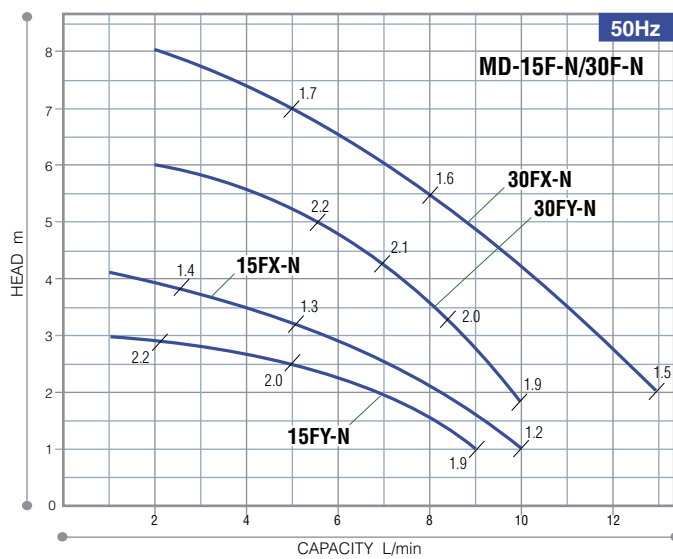
**MD-F****Performance curves**

Note: Performance is based on pumping clear water at ambient temperature. Do not run pump with discharge valve closed because pump life may be shortened.  
Figures on the performance curves shows the specific gravity limit at viscosity of 1mPa•s.

**Specifications**

50Hz/60Hz

Model	Type of Impeller	Hose connected Inlet/Outlet	Max. Capacity L/min	Max. Head m	S.G.	Motor			Mass kg
						Output W	Input W	Phase	
MD-15F-N	X	NPT1/2	10/-	4.1/-	1.2/-	10/-	38/-	1	1.8
	Y		9/10	3/4	1.9/1.3	10/10	30/34		
	Z		-/10	-/3.1	-/1.9	-/10	-/31		
MD-30F-N	X	NPT1/2 or G3/4	13/15	8/11	1.5/1.3	45/45	70/90	1	3.5
	Y		10/12	6/8	1.9/1.5	-/45	-/90		
	Z		-/11	-/7	-/1.9	-/45	-/90		
MD-55F	X	R1 or G1	65/-	7.8/-	1.3/-	90/-	170/-	1	5.4
	Y		60/65	5.4/7.8	2.0/1.3	90/90	130/170		
	Z		-/55	-/6.0	-/2.0	-/90	-/130		
MD-100F	X	R1 or G1	125/-	10.5/-	1.2/-	260/-	375/-	1 or 3	8.5
	Y		115/135	8.5/11.5	2.0/1.3	260/265	260/375		
	Z		-/115	-/8.5	-/1.9	-/265	-/285		

• Temperature range: 0 - 80°C • Ambient temperature : 0 to 40°C • Limit of viscosity: 30mPa•s (at specific gravity 1) • Slurries shorten pump life.  
• Allowable liquid temperature may depend on pumped liquid and operating condition such as heat cycles or so. Please contact us for details.

## Dimensions

Size of MD-M(Screwed connection type) is shown in ( ).

### MD

### MD-V

#### MD-6/6Z/10

Illustration shows MD-6

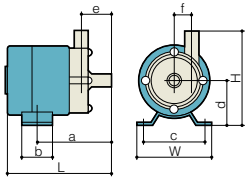

#### MD-15R(M)-N to 40R(M)-N

Illustration shows MD-30R-N

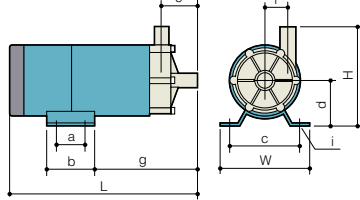

#### MD-20RZ(M)-N to 70RZ(M)-N

Illustration shows MD-20RZ-N

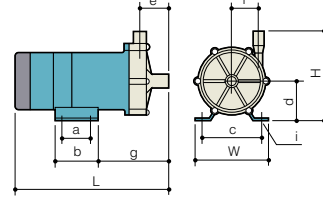

#### MD-20RX(M)-N to 40RX(M)-N

Illustration shows MD-40RX-N

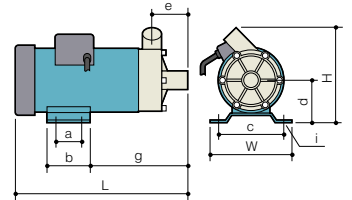

Model	W	H	L	a	b	c	d	e	f	g	i
MD-6	74	92	104	73	30	60	45	31	17	-	2 - 5.5 X9
MD-6Z											
MD-10											
MD-15R(M)-N	95	109 (114)	180 (179)	-	50	68	55	39	22	92	2 - ø5.6
MD-15RV(M)-N											
MD-20R(M)-N	106	105 (107)	203 (209)	44	60	90	45	39 (33)	29	94 (88)	4 - 6 X10
MD-30R(M)-N	120	130	248	40	64	100	60	48	31	137	4 - ø9
MD-30RV(M)-N											
MD-40R(M)-N											

220V motor is different from the above in dimensions. Please contact us for detail.

Model	W	H	L	a	b	c	d	e	f	g	i	
MD-20RZ(M)-N	106	125	211	44	60	90	55	40	39	98	4 - 6 X10	
MD-20RZV(M)-N												
MD-30RZ(M)-N	120	130	230	40	64	100	60	39	45	128	4 - ø9	
MD-30RZV(M)-N												
MD-40RZ(M)-N												
MD-40RZ-5(M)-N	130	150	241									
MD-70RZ(M)												
MD-70RZV(M)												
MD-20RX(M)-N	106	119 (122)	220	44	60	90	45	47	-	105	4 - 6 X10	
MD-30RX(M)-N	120	137 (140)	254	40	64	100	60	50		143	4 - ø9	
MD-40RX(M)-N												

### MD

### MD-V

#### MD-55R(M) to 70R(M)

Illustration shows MD-55R

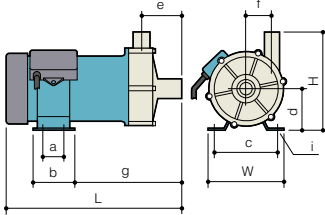

#### MD-100R(M), 100R-5(M)

Illustration shows MD-100R

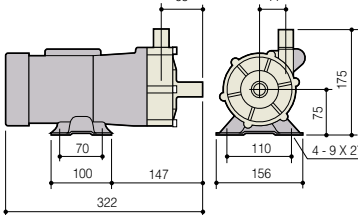

Model	W	H	L	a	b	c	d	e	f	g	i
MD-55R(M)	120	155	274	40	64	100	65	62 (61)	40	167 (166)	4 - ø9
MD-55R-5(M)										167	
MD-70R(M)	130	155	258	40	60	110	65	53	43	149	4 - 7 X11
MD-70RV(M)											

### MD-F

#### MD-15F-N, 30F-N

Illustration shows MD-15F-N

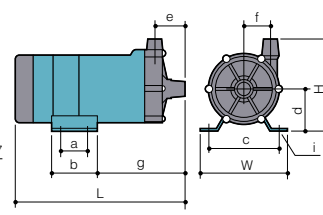

#### MD-55F, MD-100F

Illustration shows MD-100F

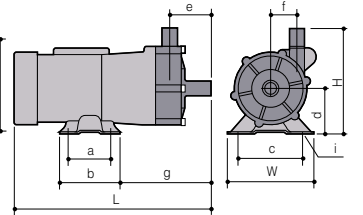

Model	W	H	L	a	b	c	d	e	f	g	i
MD-15F-N	95	120	186	-	50	68	55	34	29	99	2 - ø5.6
MD-30F-N											
MD-55F											
MD-100F	156	175	320	70	100	110	75	63	43	145	4 - 9 X 27

Dimension of G screw type of MD-30F-N, 55F and 100F models is different. Ask us for them.

## Direct pump RD series

Designed to be cool, quiet, compact and lightweight. A variety of features, including a seal-less design to prevent leakage, enables the pumps to meet a full spectrum of user needs, with emphasis on ease of installation, operation and maintenance.

Max.capacity: 20L/min  
Max.head: 10m  
Temperature range: 0 - 40°C  
Supplied power: DC14 to 24V (brushless)



RD-05



RD-30

[www.iwakipumps.jp](http://www.iwakipumps.jp)

IWAKI CO.,LTD. 6-6 Kanda-Sudacho 2-chome Chiyoda-ku Tokyo 101-8558 Japan TEL : (81)3 3254 2935 FAX : 3 3252 8892

### EUROPE / U.S.A.

European office: IWAKI Europe GmbH  
Austria : IWAKI (Austria) GmbH  
Belgium : IWAKI Belgium N.V.  
Denmark : IWAKI Nordic A/S  
Finland : IWAKI Suomi Oy  
France : IWAKI France S.A.  
Germany : IWAKI Europe GmbH  
Holland : IWAKI Holland B.V.  
Italy : IWAKI Italia S.R.L.  
Norway : IWAKI Norge AS  
Spain : IWAKI Iberica Pumps, S.A.  
Sweden : IWAKI Sverige AB  
Switzerland : IWAKI (Schweiz) AG  
U.K. : IWAKI Pumps (UK) Ltd.  
U.S.A. : IWAKI America Inc.

TEL : (49)2154 9254 0 FAX: 2154 9254 48  
TEL : (43)2236 33469 FAX: 2236 33469  
TEL : (32)13 67 02 00 FAX: 13 67 20 30  
TEL : (45)48 24 2345 FAX: 48 24 2346  
TEL : (358)9 2745810 FAX: 9 2742715  
TEL : (33)1 69 63 33 70 FAX: 1 64 49 92 73  
TEL : (49)2154 9254 50 FAX: 2154 9254 55  
TEL : (47)66 81 16 60 FAX: 66 81 16 61  
TEL : (39)02 990 3931 FAX: 02 990 42888  
TEL : (46)8 511 72900 FAX: 8 511 72922  
TEL : (34)943 630030 FAX: 943 628799  
TEL : (46)8 511 72900 FAX: 8 511 72922  
TEL : (41)26 674 93 00 FAX: 26 674 93 02  
TEL : (44)1743 231363 FAX: 1743 366507  
TEL : (1)508 429 1440 FAX: 508 429 1386

### ASIA / OCEANIA

Australia : IWAKI Pumps Australia Pty Ltd.  
China : IWAKI Pumps (Shanghai) Co., Ltd.  
Hong Kong : IWAKI Pumps Co., Ltd.  
Shanghai : IWAKI Pumps (Shanghai) Co., Ltd.  
Beijing : IWAKI Pumps Co., Ltd. (Beijing office)  
Guangzhou : GFTZ IWAKI Engineering & Trading Co., Ltd.  
Indonesia : IWAKI Singapore (Indonesia Branch)  
Korea : IWAKI Korea Co.,Ltd.  
Malaysia : IWAKI Sdn. Bhd.  
Philippines : IWAKI Chemical Pumps Philippines, Inc.  
Singapore : IWAKI Singapore Pte Ltd.  
Taiwan : IWAKI Pumps Taiwan Co., Ltd.  
Thailand : IWAKI (Thailand) Co.,Ltd.

TEL : (61)2 9899 2411 FAX : 2 9899 2421  
TEL : (852)2607 1168 FAX: 2607 1000  
TEL : (86)21 6272 7502 FAX: 21 6272 6929  
TEL : (86)10 6442 7713 FAX: 10 6442 7712  
TEL : (86)20 8435 0603 FAX: 20 8435 9181  
TEL : (62)21 6906606 FAX: 21 6906612  
TEL : (82)2 3474 0523 FAX: 2 3474 0221  
TEL : (60)3 7803 8807 FAX: 3 7803 4800  
TEL : (63)2 888 0245 FAX: 2 843 3096  
TEL : (65)6316 2028 FAX: 6316 3221  
TEL : (886)2 8227 6900 FAX: 2 8227 6818  
TEL : (66)2 322 2471 FAX: 2 322 2477

( )Country codes



Caution for safety use: Before use of pump, read instruction manual carefully to use the product correctly.

Actual pumps may differ from the photos. Specifications and dimensions are subject to change without prior notice. For further details please contact us.