

A background image of water splashing, with a vertical stream of water falling from the top and a larger splash at the bottom. The water is rendered in a light, semi-transparent style against a white background.

General Pump Control & Level Indication

Section 9

General Pump Control & Level Indication Grey Water Pump Controller



FPC-12500, FPC-12501 & FPC-12504

The MATElec Grey Water Pump Controller is designed for the management of Grey Water. Grey Water is the water discharged from baths, showers and laundries. The unique design enables the controller to monitor the levels of Grey Water in a tank and activates the pump to start and stop supply of Grey Water to selected outlets, such as the garden. If no activity (pump not worked) for 24hrs, the system will automatically activate the pump to pump out any residual Grey Water present in the tank. Controller compatible with probes and floats.

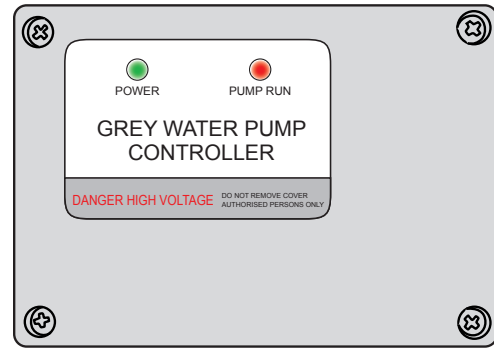

FPC-12500 "Econo"

Dimensions - 85mm (h) x 55mm (d) x 125mm (w)

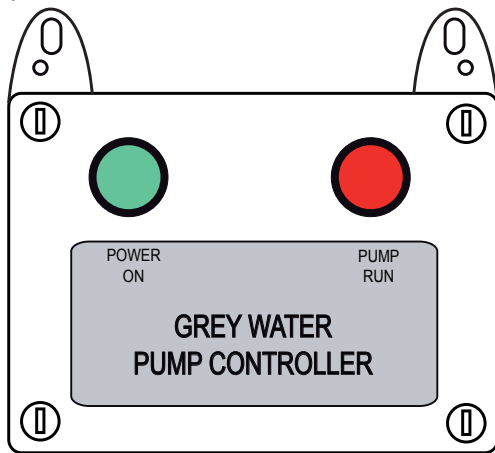

FPC-12501 "Standard"

Dimensions - 119mm (h) x 73mm (d) x 160mm (w)

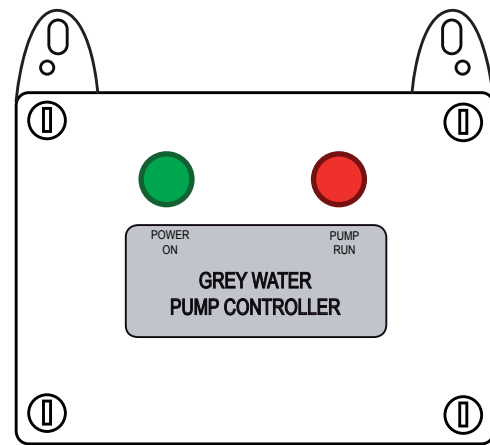

FPC-12504 "Quick Plug"

Dimensions - 119mm (h) x 73mm (d) x 160mm (w)

Schematic

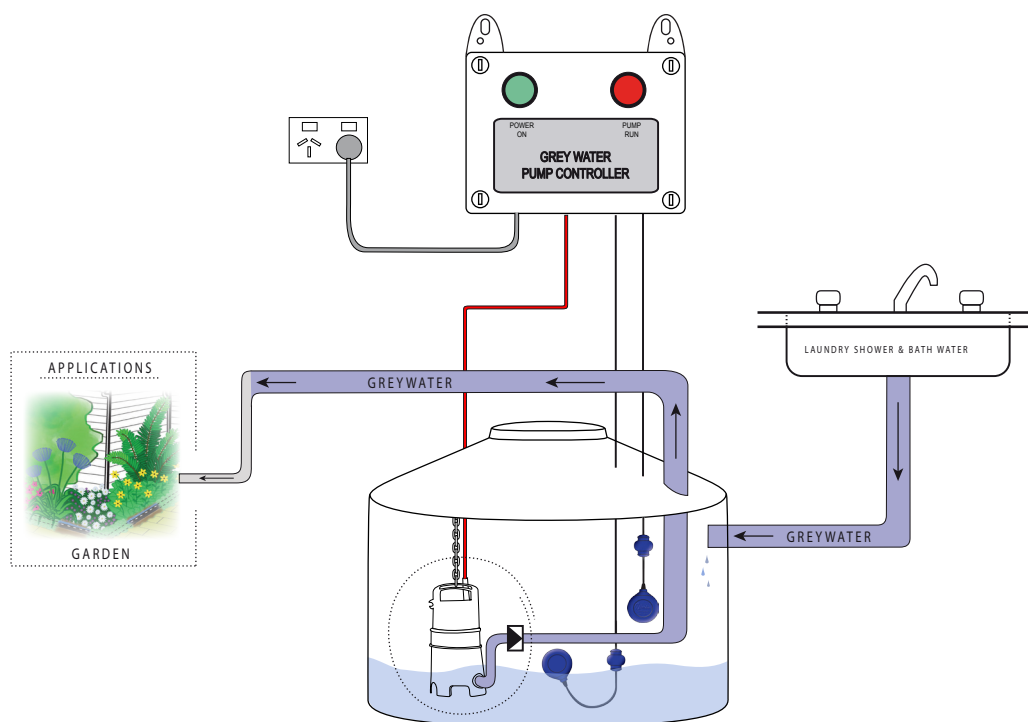

General Pump Control & Level Indication Rain/Stormwater - Tank Fill

FPC-11005 & FPC-11006

This simple, yet effective controller provides the means of controlling an automatic pump, used to transfer stormwater from a collection pit, to a storage tank. The system provides for 'Low Voltage' cabling between the float switch, situated in the storage tank, and the controller. When the storage tank is full, the controller inhibits the pump and the 'Tank Full' light is illuminated.

Features

- Automatic 'Tank Full' pump inhibitor
- 'Tank Full' indicator light
- Low voltage Float Switch circuitry
- Rated for pumps up to 8Amps
- Weatherproof polycarbonate enclosure

Schematic

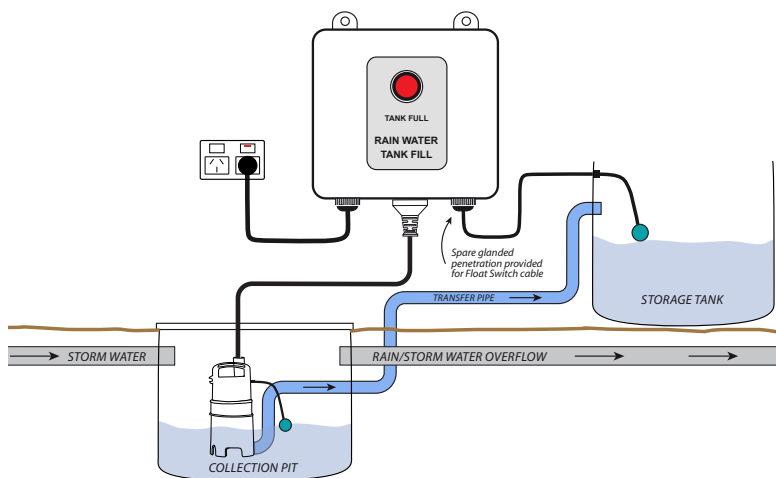

FPC-11005 - Standard Version Kit Includes

Controller Enclosure c/w power lead and moulded plug
Mounting brackets
9006 NRB 10m Cable Float Switch
Quick Plug connection for pump

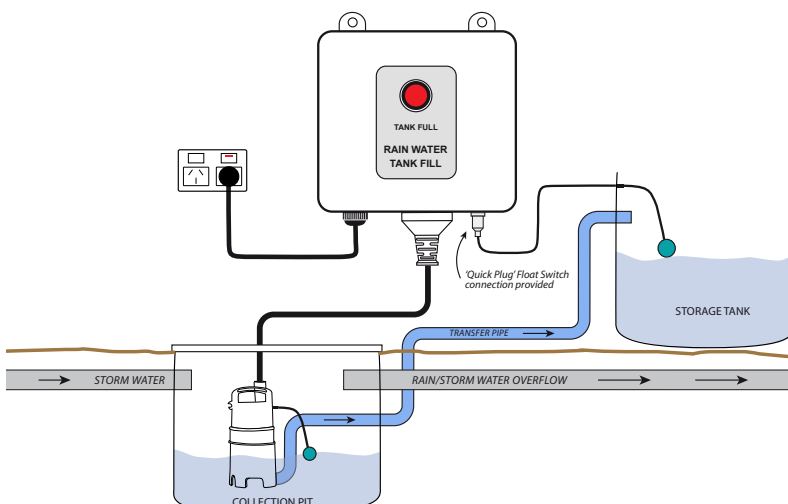

FPC-11006 - 'Quick Plug' Version Kit Includes

Controller Enclosure c/w power lead and moulded plug
Mounting brackets
9006 NRB 10m 'Quick Plug' Float Switch
Quick Plug connection for pump
Quick Plug connection for float switch

General Pump Control & Level Indication Pump Shut Off Controller



Low Level - Pump 'Shut Off' Controller FPC-11010

This simple, yet effective controller provides the means of controlling an automatic pump, used to pump water from a tank into the home. The system provides for 'Low Voltage' cabling between the float switch, situated in the storage tank, and the controller. When the storage tank is empty, the controller inhibits the pump and the 'Low Level' light is illuminated. Power to the pump is restored once water level in the tank has risen to the reset level.

Features

- 'Power on' indication
- 'Low level' indication
- 10Amp switch rating
- 'Quick Plug' pump and float switch DIY connection
- Low voltage float switch circuitry

Kit Includes

- Controller Enclosure c/w power lead and moulded plug
- Mounting brackets
- 9006 NRB 10m Cable Float Switch

Schematic

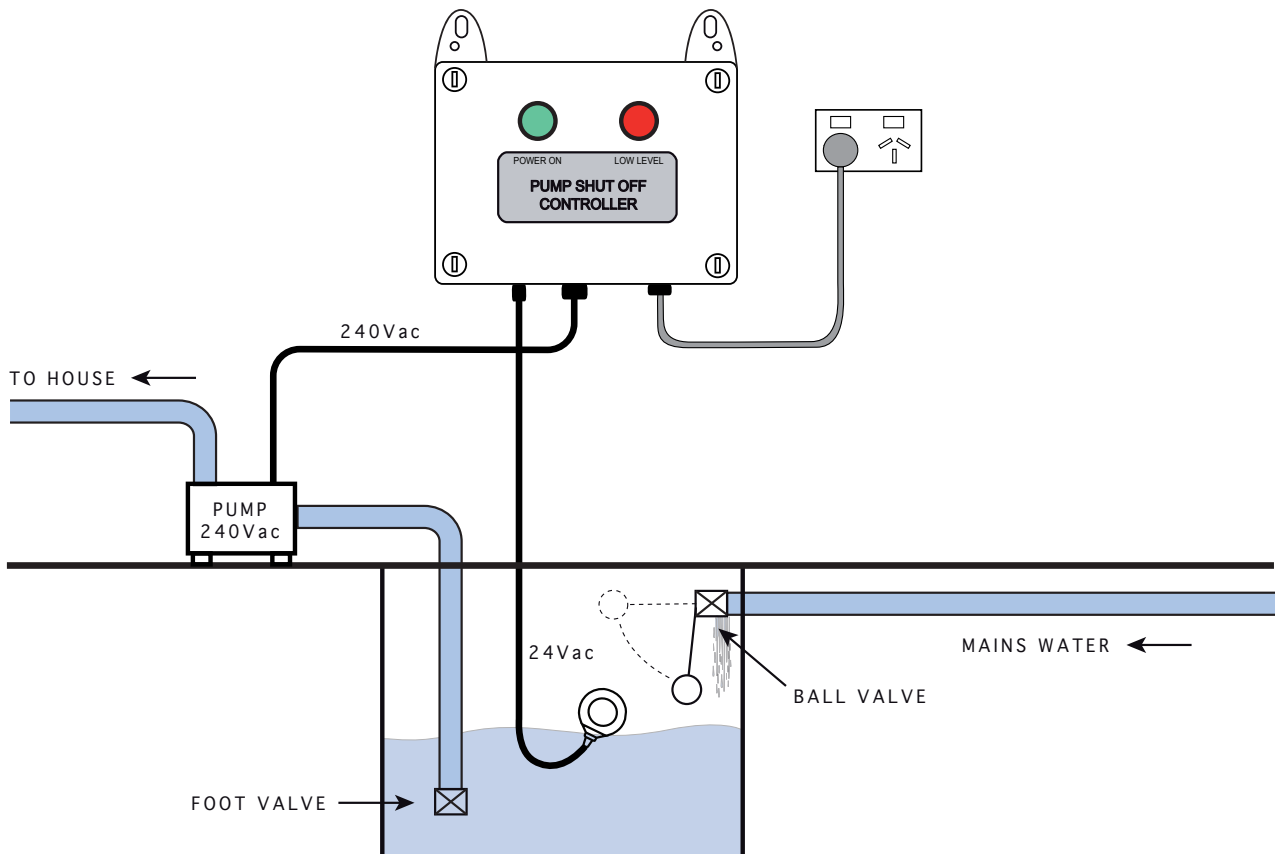

General Pump Control & Level Indication

Liquid Level Controller



FPC-12700

The MATElec Liquid Level Controller is ideal for maintaining water at predetermined levels in a tank. The controller receives inputs from a float switch, which is located in the water tank. By utilizing either the 'normally open' or the 'normally closed' output contacts, the system can be used for either filling or emptying a tank. The 24Vac output can be directly connected to a solenoid valve for mains 'top up' systems or, alternately, could be used to energise the contacts of a relay or contactor coils for pump or motor control.

Features

- Simple retro-fit
- Ideal for swimming pools, water tanks and reservoirs
- Delay in activation obviates wave induced switching
- 'Power On' and 'relay switched' indication
- Switching differential - Min 25mm
- Max 10m
- Distance of probe from electronics up to 20m

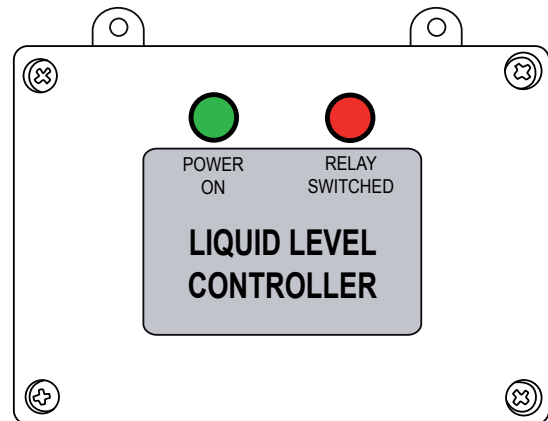

FPC-12700
Dimensions - 85mm x 55mm x 125mm

Schematic

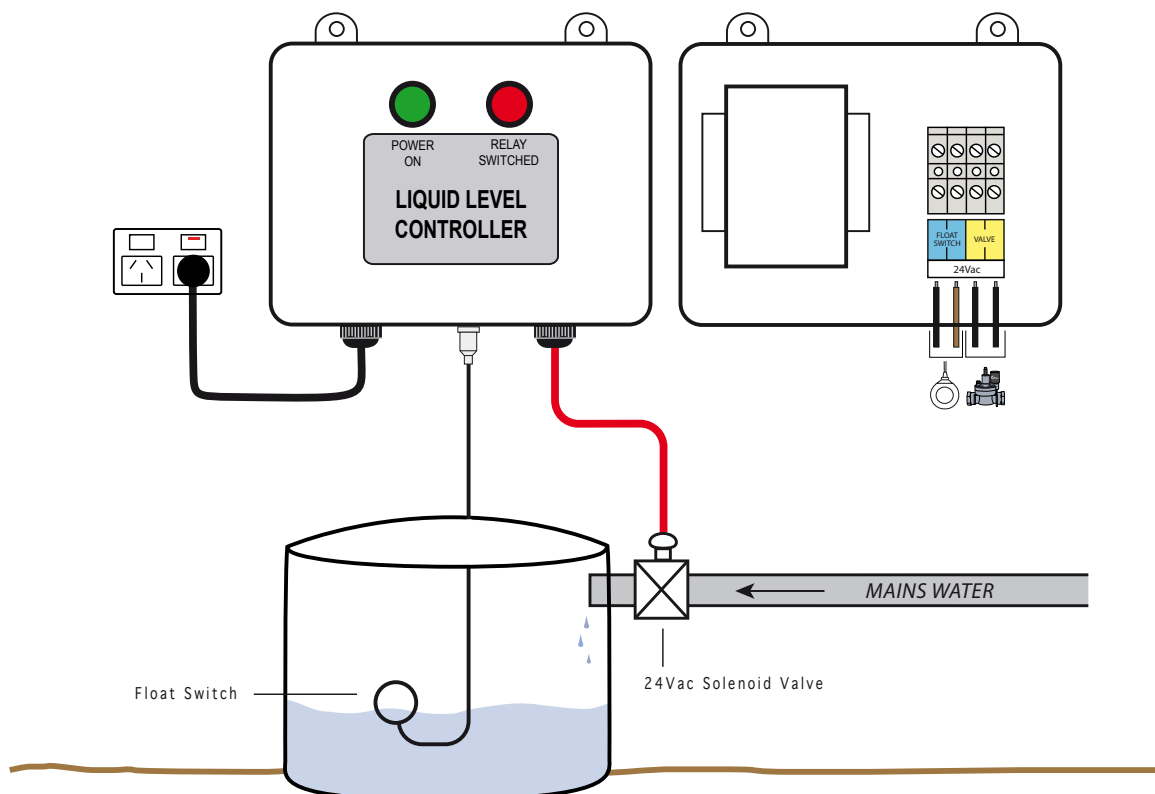

General Pump Control & Level Indication

Tank Level Indicator



FPC-12705 & FPC-12706 & FPC-12707

This simple, yet highly effective Tank Level Indicator provides an extremely accurate and informative indication of water level within a tank. The controller is coupled to a Hydrostatic Pressure Transducer, which provides a 4-20mA signal to the Process Meter. The Process Meter displays the level in very clear LED numerals.

Features

- Hydrostatic Pressure Transducer rating: 0-10m
- Process Meter has 2 relay outputs
- Display can be configured to read: m/mm (depth), percentage (full) or litres (capacity)

Optional: Sewage/Waste water Transducer available



Process Meter

Schematic

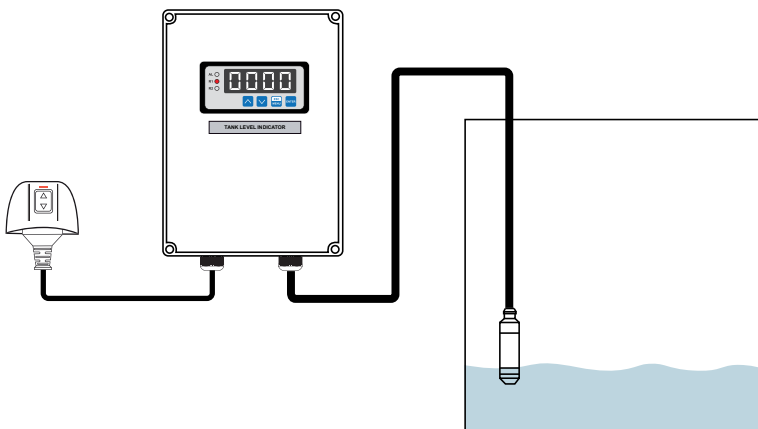

FPC-12705 Standard Version Kit Includes

Control Panel housing Process Meter
Flex & Plug for connection to Mains power
Stainless Steel Hydrostatic Pressure Transducer
c/w 10m cable

FPC-12706 Wireless Version Kit Includes

Control Panel housing Process Meter
Flex & Plug for connection to Mains power
Stainless Steel Hydrostatic Pressure Transducer
c/w 10m cable
Transmitter
Receiver

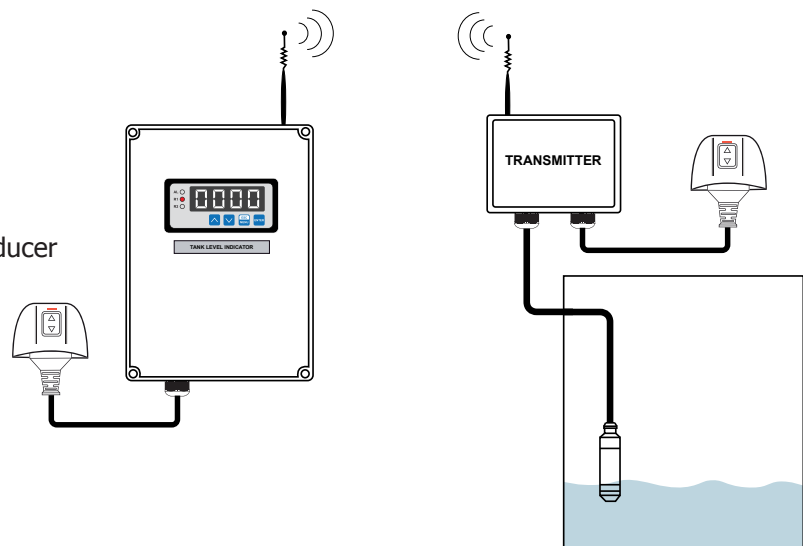

General Pump Control & Level Indication Remote Signal Communicator



Functional Overview

The MATElec Remote Signal Communicator is designed, manufactured and tested to be compatible with all MATElec liquid level control products where a switched input is required. The system, which comprises two models, mains and solar power versions, enables remote switching, necessary when interlink cabling is either not practical or too costly.

The units are set to communicate a signal burst every 60 seconds, ensuring reliability and consistency. The transmitter is supplied complete with an antenna and, where necessary, an optional antenna is available for the receiver.

Features

- No interlink cabling is required
- No costly and disruptive excavations
- Up to 500m range (conditions apply)
- Maintenance free
- Australian Standards compliant

PLEASE NOTE:

If required, the 'Receiver' Unit from either models, can be mounted within the enclosure of the controller that it is interfacing with. Pricing and implication would be enquiry specific.

Schematics

FPC-13095 Mains Powered Communicator

Kit Includes

IP55 Weatherproof Enclosures
Transmitter
Receiver

Optional Extra:
FPC-13098 Receiver Antenna

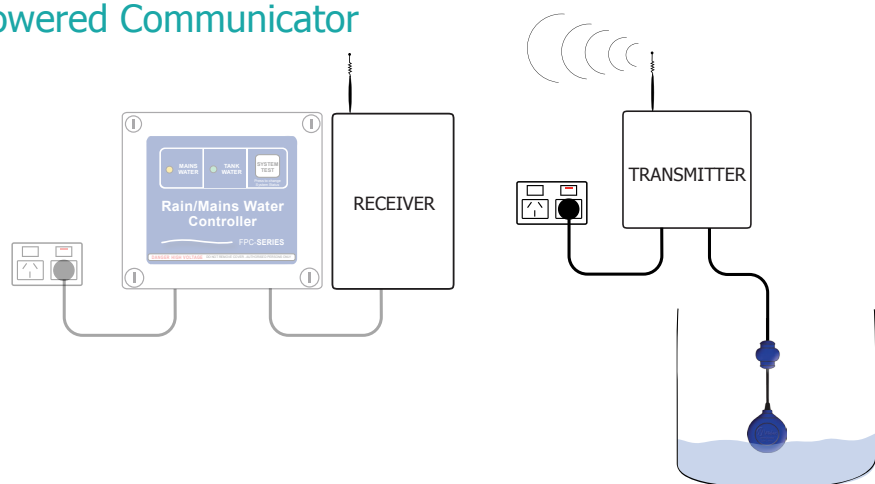

FPC-13096 Solar Powered Communicator

Kit Includes

IP55 Weatherproof Enclosures
Transmitter
Receiver
Regulator
7.2Amp/hr Battery
5W Solar Panel

Optional Extra:
FPC-13098 Receiver Antenna

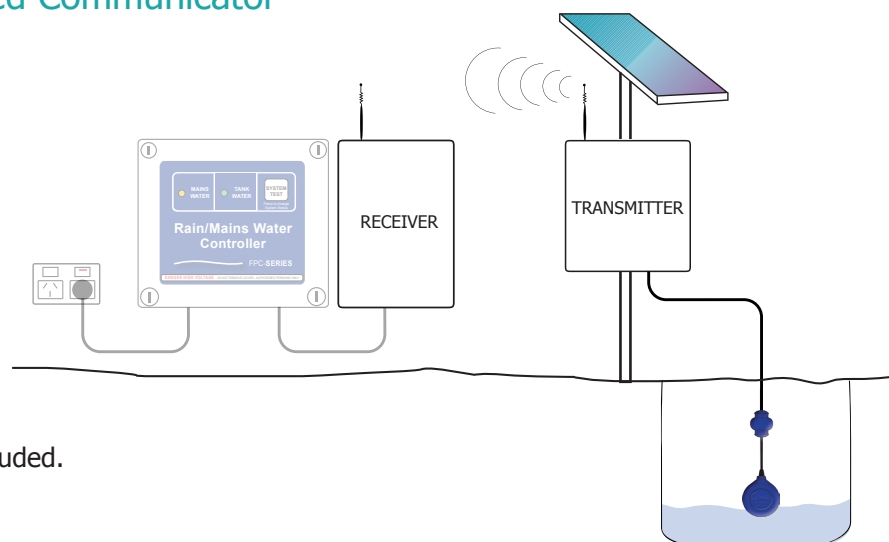

NOTE: Pole for Solar Panel not included.

General Pump Control & Level Indication Dual Water - Master Valve Controller



FPC-12765 Functional Overview

For use in conjunction with almost any irrigation controller, this unique MATElec Dual Water Master - Valve Controller, is ideal for irrigation systems, where there is a dual water source ie; Mains water and Rain water. The controller is designed to automatically select the appropriate water source for a particular watering station ie; lawns or garden beds. The controller enables the operator, at the flick of a switch, to change the water source for particular stations ensuring compliance with changing levels/stages of water restrictions.

Example of application:

With Stage 3 water restrictions in place, a home owner is only allowed to water lawn and garden with Rain water. However, with Stage 3 restrictions in place, it is permissible to water garden beds with Mains water. Should restrictions be lifted from Stage 4 to Stage 3, this change is made simple with the MATElec controller by moving the selector switch from Stage 4 to Stage 3, the rest happens automatically.

Features

- Rain water Master Valve switched indication
- Mains water Master Valve switched indication
- Simple setup of station allocation
- User friendly selection of water supply

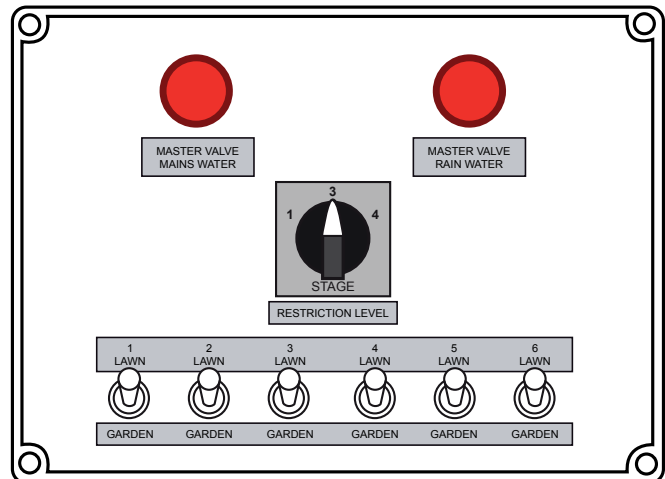

Schematic

Kit Includes

Controller c/w selector switches and indicator lights
Terminations for inputs from irrigation controller
Terminations for outputs to solenoid valves

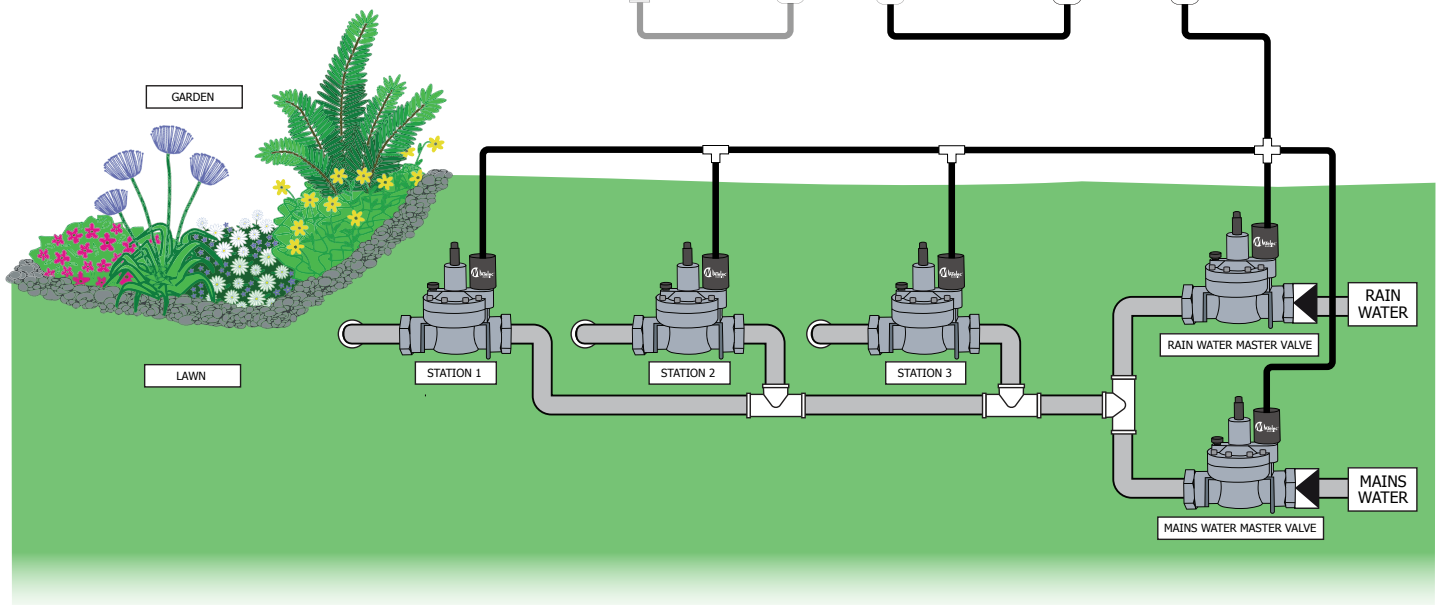
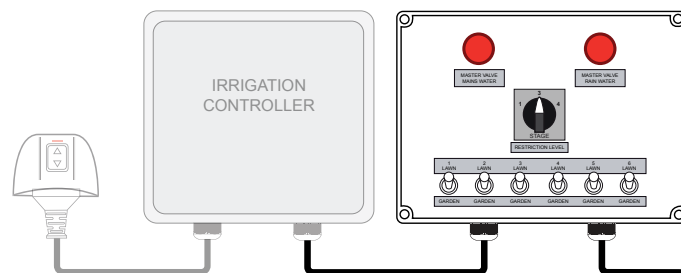

General Pump Control & Level Indication Leak Detection & Mains Water Isolator



FPC-12742 Functional Overview

This controller has been developed for areas where there is a risk of a major leak or spill that could occur at any time, which requires the automatic shut-off of the Mains water supply.

The system is made up of a controller complete with status indication, a moisture/water detection probe and a specifically engineered DC Pulse Latching Solenoid Valve.

Features

- Continuous Monitoring
- Clear Status Indication
- Power Fail-Valve Closed feature
- Manual Override
- BMS available as V/F Contacts

Available Valve Sizes

Size	Flow ℓ /min "MAX"
25mm	120
40mm	300
50mm	450

Kit Includes

- Powder Coated Control Panel
- Conductivity probe c/w 10m Cable
- 316 Stainless Steel Saddle
- Valve c/w DC Pulse Latching Solenoid

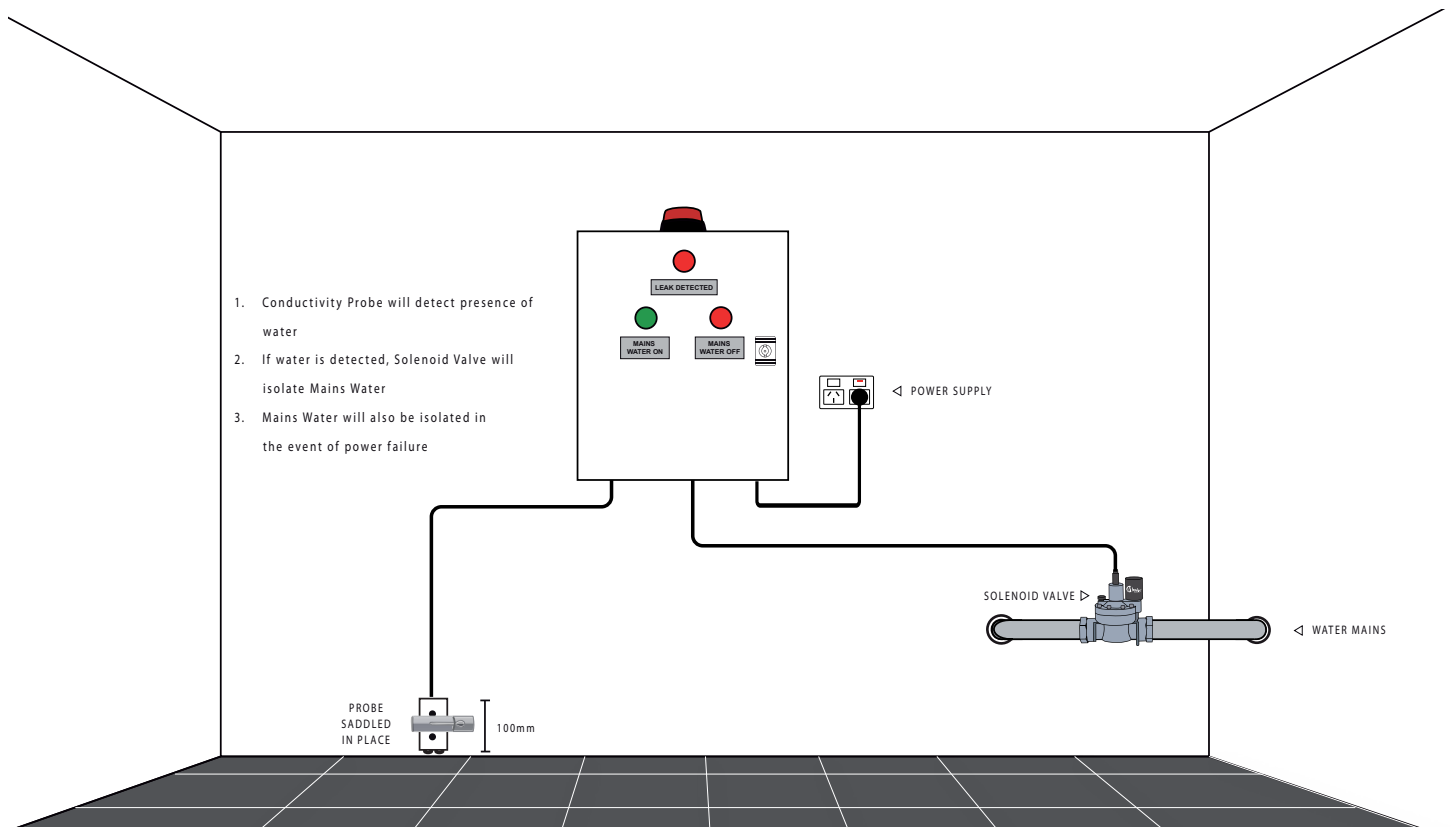
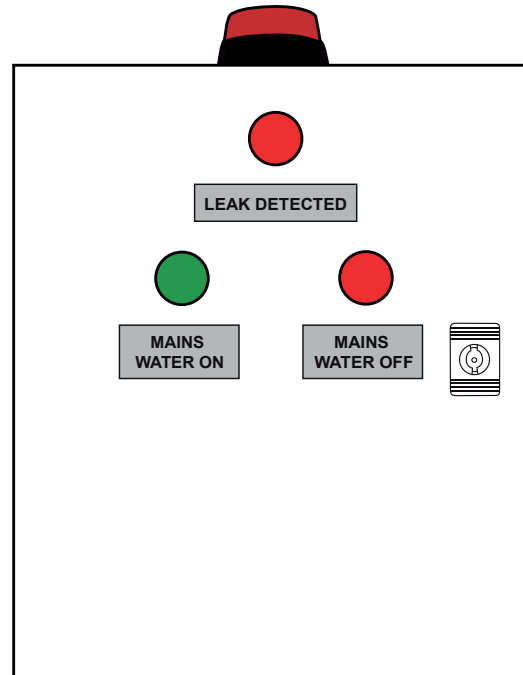

General Pump Control & Level Indication Intrinsically Safe Pump Start Switch



FPC-15805 Functional Overview

It is a common requirement for applications where fuels and hydrocarbons could potentially be present, to have an Intrinsically Safe Installation specified. Whilst many pumps have the appropriate Ex approvals for these applications, accredited level switches, that provide the Start and Stop signal for these pumps are difficult to come by.

The MATElec Intrinsically Safe Pump Start Switch Controller provides a simple yet effective solution for these installations.

Incorporating an Intrinsically Safe Barrier Relay, the controller is designed to switch a 240Vac Pump utilising a standard float style switch.

Features

- 240Vac 10amp Pump Switching
- Poly Carbonate Weatherproof Enclosure
- LED Status Indication on Barrier Relay

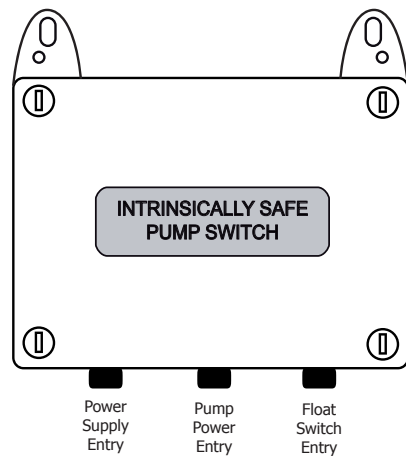

Under Lid

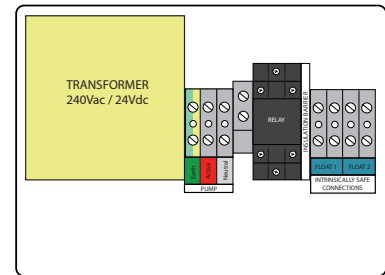

Inside Componentry

Schematic

