

**PUMPSET ASSEMBLY - PLAN VIEW**  
(ENCLOSURE NOT SHOWN)

SCALE 1:15

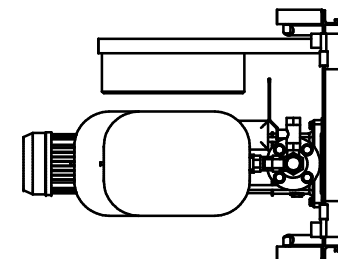

**PUMPSET ASSEMBLY - END VIEW**  
(ENCLOSURE NOT SHOWN)

SCALE 1:15

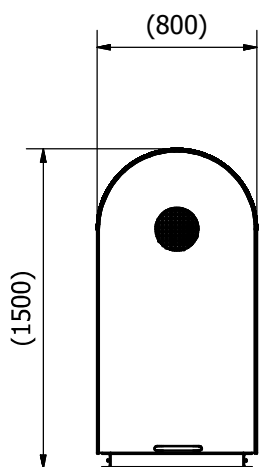

**END VIEW**  
(CLOSED)

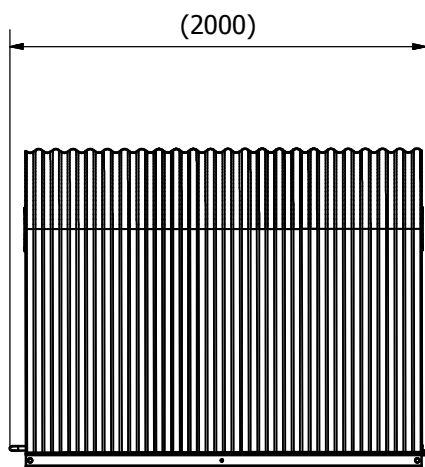

**FULL ASSEMBLY - SIDE VIEW**  
(CLOSED)

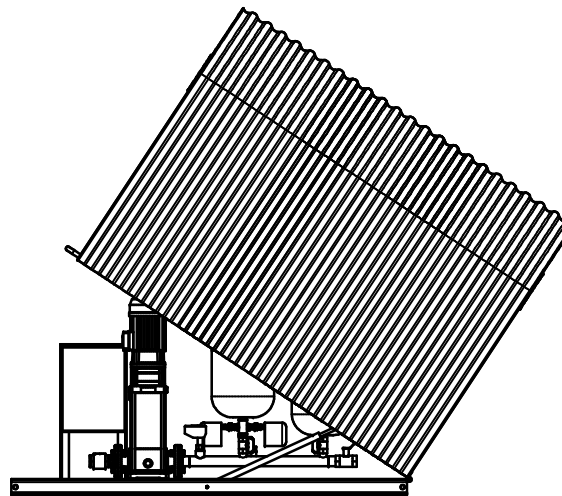

**FULL ASSEMBLY - SIDE VIEW**  
(PARTIALLY OPEN)

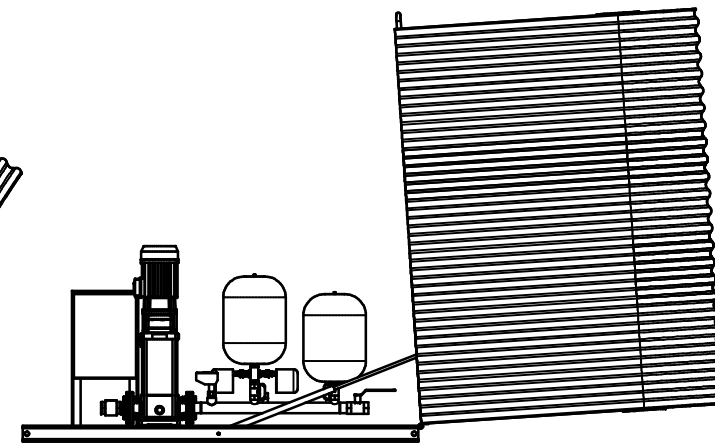

**FULL ASSEMBLY - SIDE VIEW**  
(OPEN)

**TOLERANCES**  
UNLESS SPECIFIED

0 MM	± 1MM
0.0 MM	± 0.5MM
0.00 MM	± 0.1MM
0.000 MM	± 0.01MM
ANGULAR	± 0.5DEG

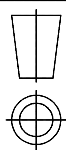

DRAWN.	PJH
DATE.	4/04/2011
CHECKED.	
SCALE.	1:25

**POWER PUMPS**  
& ENG. PTY LTD.



15 ROXBURGH AVENUE,  
LONSDALE S.A. 5160.

COMPANY. Power Pumps & Engineering

TITLE. Single Pump Pressure System

DRAWING No. DWG-TEMP REV No. A

**A3**

SHT 1

OF 1

JOB #

ITEM #

QUANTITY

MATERIAL

FINISH

MACHINE ALL FACES N8 OR UNLESS SPECIFIED  
CHAMFER ALL HOLES 1.0x45°  
DEBUR ALL SHARP EDGES

NOTES.